

PERMIT  
 CITY OF NAPOLEON, OHIO - BUILDING DEPARTMENT  
 255 West Riverview Avenue, Napoleon, Ohio 43545 - (419) 592-4010

Permit No. <u>3709</u> Issued <u>10/12/95</u>		FEES	BASE	PLUS	TOTAL
Job Location <u>880 Westchester</u>	<input checked="" type="checkbox"/>	Building	\$ <u>9.00</u>	\$ <u>56.00</u>	\$ <u>65.00</u>
Lot _____	<input checked="" type="checkbox"/>	Electrical	\$ _____	\$ <u>6.00</u>	\$ <u>6.00</u>
Issued by <u>Brent N. Damman</u>	<input type="checkbox"/>	Plumbing	\$ _____	\$ _____	\$ _____
Owner <u>Steve Sehlmeier 599-9676</u>	<input type="checkbox"/>	Mechanical	\$ _____	\$ _____	\$ _____
Address <u>880 Westchester</u>	<input type="checkbox"/>	Demolition	\$ _____	\$ _____	\$ _____
Agent <u>Mock/Buehrer 592-0825</u>	<input type="checkbox"/>	Zoning	\$ _____	\$ _____	\$ _____
Address <u>1227 Dodd St.</u>	<input type="checkbox"/>	Sign	\$ _____	\$ _____	\$ _____
Use Type - Residential <u>X</u>	<input type="checkbox"/>	Water Tap	\$ _____	\$ _____	\$ _____
Other - Describe _____	<input type="checkbox"/>	Sew. Insp.	\$ _____	\$ _____	\$ _____
No. Dwelling Units _____	<input type="checkbox"/>	Sewer Tap	\$ _____	\$ _____	\$ _____
New _____ Replacement _____	<input type="checkbox"/>	Temp. Water	\$ _____	\$ _____	\$ _____
Add'n. <u>X</u> Alter _____ Remodel _____	<input type="checkbox"/>	Temp. Elec.	\$ _____	\$ _____	\$ _____
Fixed Occupancy _____		TOTAL FEES.....			\$ <u>71.00</u>
Change of Occupancy _____		LESS FEES PAID.....			\$ _____
Estimated Cost \$ <u>14000.00</u>		BALANCE DUE.....			\$ _____

ZONING INFORMATION

district	lot dimensions	area	front yd	side yd	rear yd
max hgt	no pkg spaces	no ldg spaces	max cover	petition or appeal req'd	date appr

WORK INFORMATION

Size: Length \_\_\_\_\_ Width \_\_\_\_\_ Stories \_\_\_\_\_ Ground Floor Area \_\_\_\_\_

Height \_\_\_\_\_ Building Volume (for Demo. Permit) \_\_\_\_\_

Electrical: \_\_\_\_\_

Plumbing: \_\_\_\_\_

Mechanical: \_\_\_\_\_

Additional Information: 14' x 18' family room

Date \_\_\_\_\_ Applicant Signature \_\_\_\_\_



MOCK - RUEHREK

**APPLICATION FOR**

Residential, Building, Electrical, Plumbing, Mechanical, and Demolition Permit

FROM - The City of Napoleon, Ohio, Building Department

255 West Riverview Avenue; P.O. Box 151; Napoleon, Ohio 43545 - Telephone (419) 592-4010

ENTRY NO. \_\_\_\_\_

PERMIT NO. 3709 ISSUED 10-12-95 (X) Building \$ 9.00 \$ 56.00 \$ 65.00

JOB LOCATION 880 WESTCHESTER (X) Electrical \$ \_\_\_\_\_ \$ 6.00 \$ 6.00

LOT \_\_\_\_\_ ( ) Plumbing \$ \_\_\_\_\_ \$ \_\_\_\_\_ \$ \_\_\_\_\_  
(Subdivision or Legal Description)

ISSUED BY BND ( ) Mechanical \$ \_\_\_\_\_ \$ \_\_\_\_\_ \$ \_\_\_\_\_  
(Building Official) ( ) Demolition \$ \_\_\_\_\_ \$ \_\_\_\_\_ \$ \_\_\_\_\_

OWNER STUE SEHMEYER PHONE 599-9676 ( ) Zoning \$ \_\_\_\_\_ \$ \_\_\_\_\_ \$ \_\_\_\_\_

ADDRESS 880 WESTCHESTER Nap ( ) Sign \$ \_\_\_\_\_ \$ \_\_\_\_\_ \$ \_\_\_\_\_

AGENT Mock/Buchner PHONE 592-0825 ( ) Water Tap \$ \_\_\_\_\_ \$ \_\_\_\_\_ \$ \_\_\_\_\_

ADDRESS 1227 Dodd Napoleon, Ohio ( ) Sewer Tap \$ \_\_\_\_\_ \$ \_\_\_\_\_ \$ \_\_\_\_\_

USE: (X) Residential ( ) Commercial ( ) Industrial ( ) Temp Water \$ \_\_\_\_\_ \$ \_\_\_\_\_ \$ \_\_\_\_\_  
( ) Other \_\_\_\_\_ ( ) Temp Elec. \$ \_\_\_\_\_ \$ \_\_\_\_\_ \$ \_\_\_\_\_

WORK: ( ) New ( ) Addition (X) Replacement ( ) Remodel

ESTIMATED COST = \$ 14000.00

Additional Structure \_\_\_\_\_ Hours \_\_\_\_\_  
Plan Review: Electric \_\_\_\_\_ Hours \_\_\_\_\_

TOTAL FEES . . . . . \$ 71.00  
Less Fees Paid . . . . . \$ \_\_\_\_\_  
BALANCE DUE . . . . . \$ 71.00

**ZONING INFORMATION**

District	Lot Dimensions	Area	Front Yard	Side Yard	Rear Yard
----------	----------------	------	------------	-----------	-----------

Max Height	No. Pkg. Spaces	No. Ldg. Spaces	Max Cover	Petition or Appeal Required-Date
------------	-----------------	-----------------	-----------	----------------------------------

**WORK INFORMATION**

Building: Ground Floor Area \_\_\_\_\_ sq. ft. Basement Floor Area \_\_\_\_\_ sq. ft.

Garage Floor Area \_\_\_\_\_ sq. ft. 2nd Floor Area \_\_\_\_\_ sq. ft. Other \_\_\_\_\_ sq. ft.

Size: Length \_\_\_\_\_ Width \_\_\_\_\_ Stories \_\_\_\_\_ Height \_\_\_\_\_

Building Volume (for Demolition Permit) \_\_\_\_\_ cubic feet

Description of Work: 14' x 18' FAMILY ROOM

**ELECTRICAL:** Contractor \_\_\_\_\_ Phone \_\_\_\_\_

Address \_\_\_\_\_ ESTIMATED COST = \$ \_\_\_\_\_

**Type of Work:** ( )New ( )Service Change ( )Rewiring ( )Add'l Wiring TEMPORARY ELEC. REQUIRED - ( )Yes ( )No

Size of Service \_\_\_\_\_ Underground \_\_\_\_\_ Overhead \_\_\_\_\_ Number of New Circuits 2

**Description of Work:** \_\_\_\_\_

**PLUMBING:** Contractor \_\_\_\_\_ Phone \_\_\_\_\_

Address \_\_\_\_\_ ESTIMATED COST = \$ \_\_\_\_\_

WATER TAP REQUIRED - ( )Yes ( )No Size \_\_\_\_\_ Type of Pipe \_\_\_\_\_ Water Dist. Pipe \_\_\_\_\_

SANITARY SEWER TAP REQUIRED - ( )Yes ( )No Size \_\_\_\_\_ Type of Pipe \_\_\_\_\_ Dr. Waste Vt. Pipe \_\_\_\_\_

STREET SEWER TAP REQUIRED - ( )Yes ( )No Type of Pipe \_\_\_\_\_ STREET TO BE OPENED - ( )Yes ( )No

Main Building Drain Size = \_\_\_\_\_ Main Vent Pipe Size = \_\_\_\_\_

**LIST NUMBER OF PLUMBING FIXTURES BELOW:**

Water Closets = \_\_\_\_\_ Bathtubs = \_\_\_\_\_ Showers = \_\_\_\_\_ Lavatories = \_\_\_\_\_ Kitchen Sinks = \_\_\_\_\_ Disposal = \_\_\_\_\_

Clothes Washer = \_\_\_\_\_ Floor Drains = \_\_\_\_\_ Dishwasher = \_\_\_\_\_ Other \_\_\_\_\_ Total = \_\_\_\_\_

**Description of Work:** \_\_\_\_\_

**MECHANICAL:** Contractor \_\_\_\_\_ Phone \_\_\_\_\_

Address \_\_\_\_\_ ESTIMATED COST = \$ \_\_\_\_\_

HEATING SYSTEM - ( )Forced Air ( )Gravity ( )Hot Water ( )Steam ( )Unit Heaters ( )Radiant ( )Baseboard

TYPE OF FUEL - ( )Electric ( )Natural Gas ( )Propane ( )Wood ( )Coal ( )Solar ( )Geothermal Other \_\_\_\_\_

NUMBER OF HEAT ZONES = \_\_\_\_\_ HOT WATER - ( )One (1) Pipe ( )Two (2) Pipes ( )Series Loop

ELECTRIC HEAT - Number of Circuits \_\_\_\_\_ Number of Furnaces \_\_\_\_\_ Number of Hot Air Runs \_\_\_\_\_

Number of Hot Water Radiators \_\_\_\_\_ Total Heat Loss \_\_\_\_\_ Rated Capacity of Furnace/Boiler \_\_\_\_\_

LOCATION OF HEATING UNITS - ( )Crawl Space ( )Floor Level ( )Attic ( )Suspended ( )Roof ( )Outside

**Description of Work:** \_\_\_\_\_

**DRAWINGS REQUIRED:** All applications must be accompanied by two (2) complete sets of Drawings including Site Plans, Foundation Plans, Floor Plans, Structural Framing Plans, Exterior Elevations, Section and Details, Stair Details, Electrical Layout, Plumbing Isometric, Heating Layout, etc. All Plans shall be drawn to scale, show all existing structure on the Site Plans, and show electric panel and furnace locations.

**READ AND SIGN BELOW:** The undersigned hereby makes application for a Permit for all work described herein and agrees to complete the work in strict accordance with all applicable provisions of the current edition of the C.A.B.O. Building Code, the Napoleon Building and Zoning Codes, the Napoleon Engineering Department Rules and Regulations, Standard Specifications and other pertinent sections of the Napoleon Code of Ordinances.

Signature of Applicant \_\_\_\_\_ Date \_\_\_\_\_

NAPOLEON BUILDING DEPARTMENT (SAMPLE DRAWING)

880 Westchester

- VENTS RIDGE
- ROOFING 240# ASPHALT
- UNDERLAYMENT 7/16 OSB 15# FELT
- SHEATHING 7/16 OSB

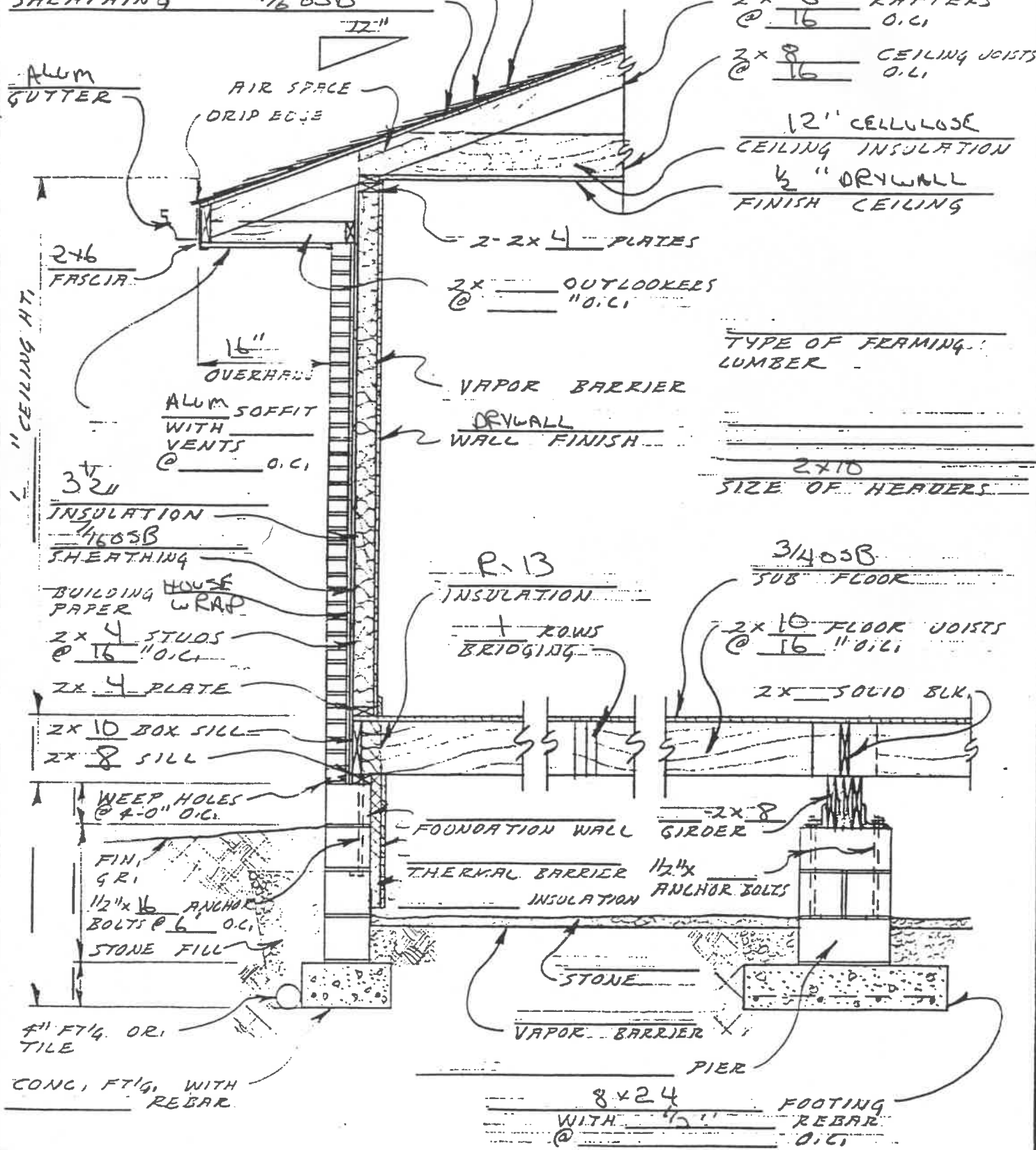

- 2x 6 RAFTERS @ 16 O.C.
- 2x 8 CEILING JOISTS @ 16 O.C.

- 12" CELLULOSE CEILING INSULATION
- 1/2" DRYWALL FINISH CEILING

TYPE OF FRAMING: LUMBER

2x10 SIZE OF HEADERS

3/4 OSB SUB FLOOR

2x10 FLOOR JOISTS @ 16" O.C.

2x SOLID BLK.

2x8 GIRDER

1 1/2" x ANCHOR BOLTS

8x24 FOOTING WITH 1 1/2" REBAR @ O.C.

DATE \_\_\_\_\_ WALL SECTION - BRICK VENEER \_\_\_\_\_ DWG N° OF \_\_\_\_\_

